

SWSM01 Series Dual Axis joystick

Product Features

- **Compact Design:** Ideal control panel and armrest configuration.
- **Reliability:** Utilizes non-contact Hall effect sensors to enhance durability.
- **IP67 Rating:** Dustproof and waterproof, suitable for harsh environments.
- **Customizable Configuration:** Options for spring return, splitter, and variable resistance.
- **Custom Colors:** Handles available in a variety of colors to match design preferences.



Application

- **Industrial controller:** Suitable for a range of industrial remote controls.
- **Control Panel:** Seamlessly integrated into various control systems.
- **Handrails:** Perfect for mechanical and equipment handrails.

Product configuration

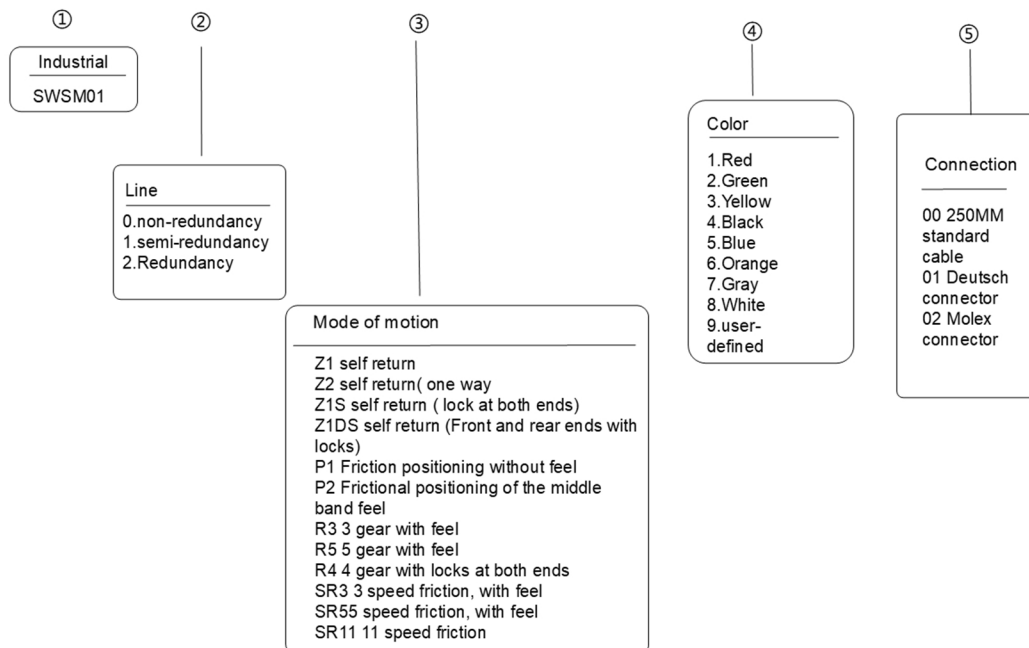

Product Size

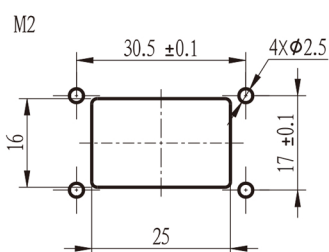
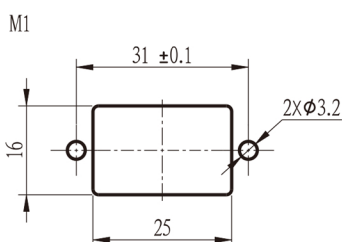
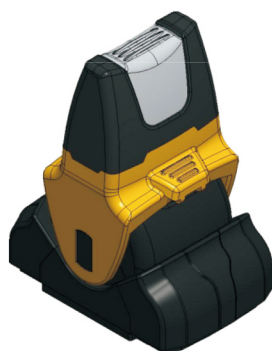
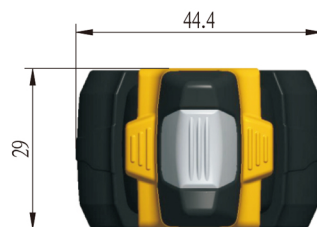
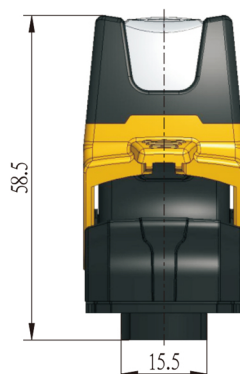
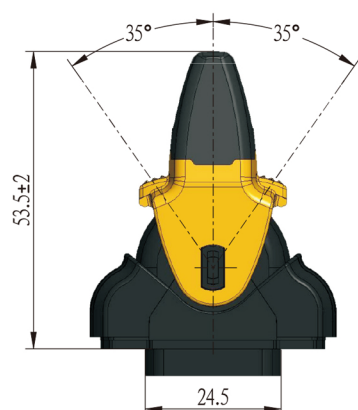

1:1

Circuit

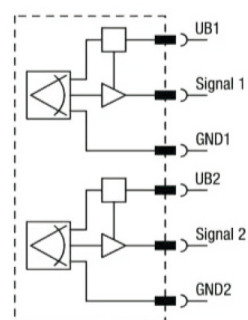
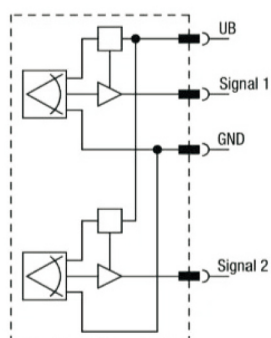
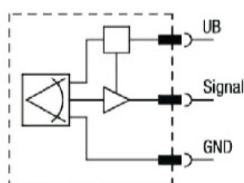

Analog

Analog semi-redundancy

Analog redundancy